

SNR-S2995G-24TX

Managed L3 Ethernet Switch

Quick Install Guide

SNR-S2995G-24TX Quick Install Guide

This guide describes the steps of installing the switch, including the basic introduction to the product, the basic installation steps, etc.

1. Front and back panels description

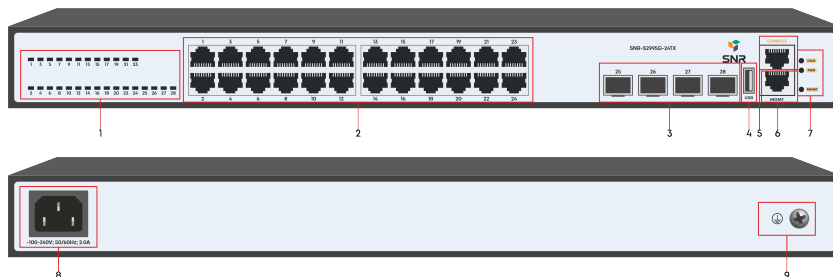

Nº	Наименование	Описание	
1	1-28	Port status LEDs	
		Off	No link on port
		Green	The port has a valid link
		Green (Blink)	Blinking indicates activity on port
2	Ports 1-24	10/100/1000BaseT Ports	
3	Ports 25-28	SFP+ 1/10GbE Ports	
4	USB	USB port	
5	Console	Console port	
6	MGMT	Management port	
7	DIAG	Switch status LED	
		Green	System is starting or abnormal
		Green (Blink)	System works normally
	PWR	Power LED	
		Green	Internal/External power is operating normally
		Off	Power off
	MGMT	Management port LED	
		Green	No link on port
		Green (Blink)	The port has a valid link
		Off	Blinking indicates activity on port
8	100-240V~ 50/60Hz	The AC power socket, AC rated voltage range: 100-240V AC; 50/60Hz	
9	Grounding	The Grounding bolt	

2. Switch installation

Before installation, take ECD-preventive measures, such as wearing the ESD-preventive gloves or a wrist strap.

2.1 Install the Device in a 19" Cabinet

Fix the Rack Mount Brackets.

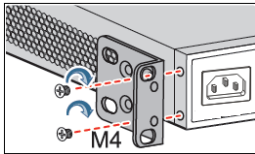

Fix the captive nuts, and install the device in a cabinet. Attention: leave more than 1U space between the devices for proper heat dissipation.

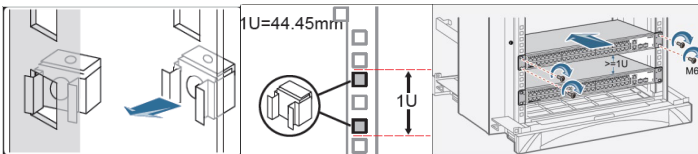

2.2 Install the Device on a Worktable

Stick the rubber gasket, and install the device on a worktable.

2.3 Connect the PGND cable and power cable

Connect grounding cable to the ground bus and to the switch.

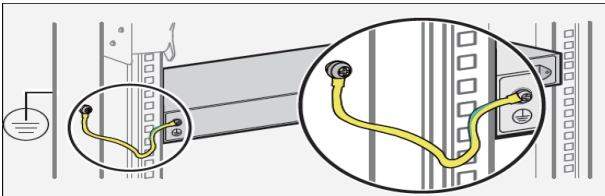

Connect the AC power cable.

3. Access to initial switch configuration

3.1 Access to the switch via console

Connect console cable to switch via RJ-45 connector and another side to RS-232 port of the PC. Settings of the COM-port are below.

Parameter	Value
Bitrate	115200
Databits	8
Parity	None
StopBits	1
FlowControl	None

Use default username admin and password admin to access the switch.

3.2 Access to the switch via Ethernet port

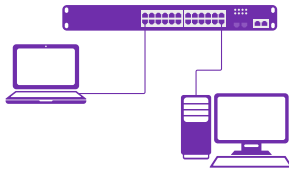

Connect the Switch with the PC NIC interface. Power on the Switch. Check whether the IP-address of the computer is within this network segment: 192.168.1.xxx ("xxx" ranges 2~254), for example, 192.168.1.100. Open the browser, and enter `http://192.168.1.1` and then press «Enter» or open telnet connection to address 192.168.1.1.

Parameter	Value
Switch default IP-address	192.168.1.1
Default username	admin
Default password	admin

4. Technical support

NAG service and technical support center:

NAG LLC

Address: Office M-03, Al Garhoud Business center Building. UAE, Dubai

Website: snr.global

Technical support portal: snr.support

Tel: +971 0 42599967