

SNR-S2995G-24TX-POE

Managed PoE Layer 3 Switch

Quick Install Guide



SNR-S2995G-24TX-POE Quick Install Guide

This guide describes the steps of installing the switch, including the basic introduction to the product, the basic installation steps, etc.

1. Front and back panels description

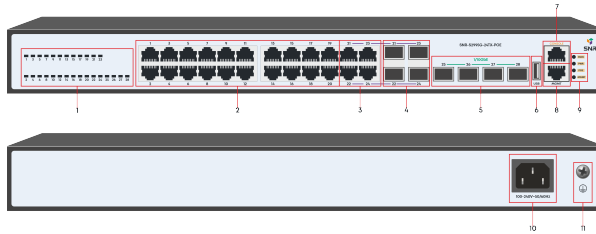

No.	Name	Description	
1	1-28	Port activity indicators	
		Off	The port is disabled or connection not established
		Green	Connection established on port
		Green flashing	Data transfer in progress
2	1-20	10/100/1000BaseT ports	
3	21-24	Combo RJ45 10/100/1000BaseT ports	
4	21-24	Combo SFP 100/1000BaseX ports	
5	25-28	SFP+ 1/10GbE ports	
6	USB	USB port	
7	Console	Console port	
8	MGMT	Dedicated management port	
9	DIAG	Switch operation status indicator	
		Green	The switch is loading or it doesn't work correctly
		Green flashing	The switch is working fine.
	PWR	Power indicator	
		Green	Power is connected
		Off	There is no power supply
	MGMT	Management Port LED	
		Off	The port is disabled or connection not established
		Green	Connection established on port
		Green flashing	Data transfer in progress
	POE	PoE status indicator	
		Green	PoE works fine
Off		PoE is off	

10	100-240V~ 50/60Hz	AC power connector: 100-240V AC; 50/60 Hz
11	Grounding	Grounding bolt for the switch

2. Switch installation

Before installation, take ECD-preventive measures, such as wearing the ESD-preventive gloves or a wrist strap.

2.1 Install the Device in a 19" Cabinet

Fix the Rack Mount Brackets.

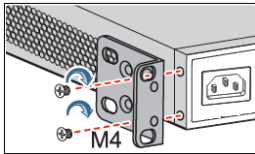

Fix the captive nuts, and install the device in a cabinet. Attention: leave more than 1U space between the devices for proper heat dissipation.

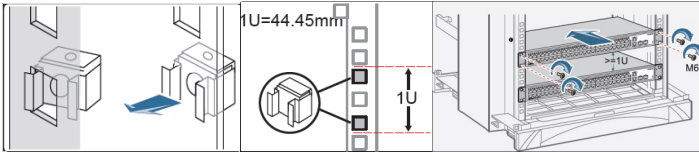

2.2 Install the Device on a Worktable

Stick the rubber gasket, and install the device on a worktable.

2.3 Connect the PGND cable and power cable

Connect grounding cable to the ground bus and to the switch.

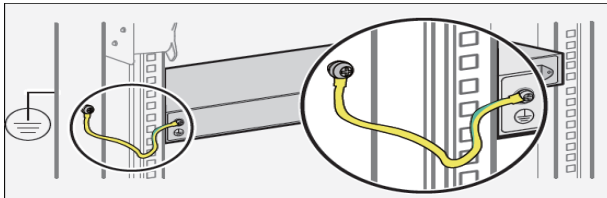

Connect the AC power cable.

3. Access to initial switch configuration

3.1 Access to the switch via console

Connect console cable to switch via RJ-45 connector and another side to RS-232 port of the PC. Settings of the COM-port are below.

Parameter	Value
Bitrate	115200
Databits	8
Parity	None
StopBits	1
FlowControl	None

Use default username admin and password admin to access the switch.

3.2 Access to the switch via Ethernet port

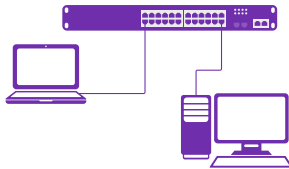

Connect the Switch with the PC NIC interface. Power on the Switch. Check whether the IP-address of the computer is within this network segment: 192.168.1.xxx ("xxx" ranges 2~254), for example, 192.168.1.100. Open the browser, and enter `http://192.168.1.1` and then press «Enter» or open telnet connection to address 192.168.1.1.

Parameter	Value
Switch default IP-address	192.168.1.1
Default username	admin
Default password	admin

4. Technical support

NAG service and technical support center:

NAG LLC

Address: Office M-03, Al Garhoud Business center Building. UAE, Dubai

Website: snr.global

Technical support portal: snr.support

Tel: +971 0 42599967