

# H3C WA6520 Access Point Installation Quick Start-AW102

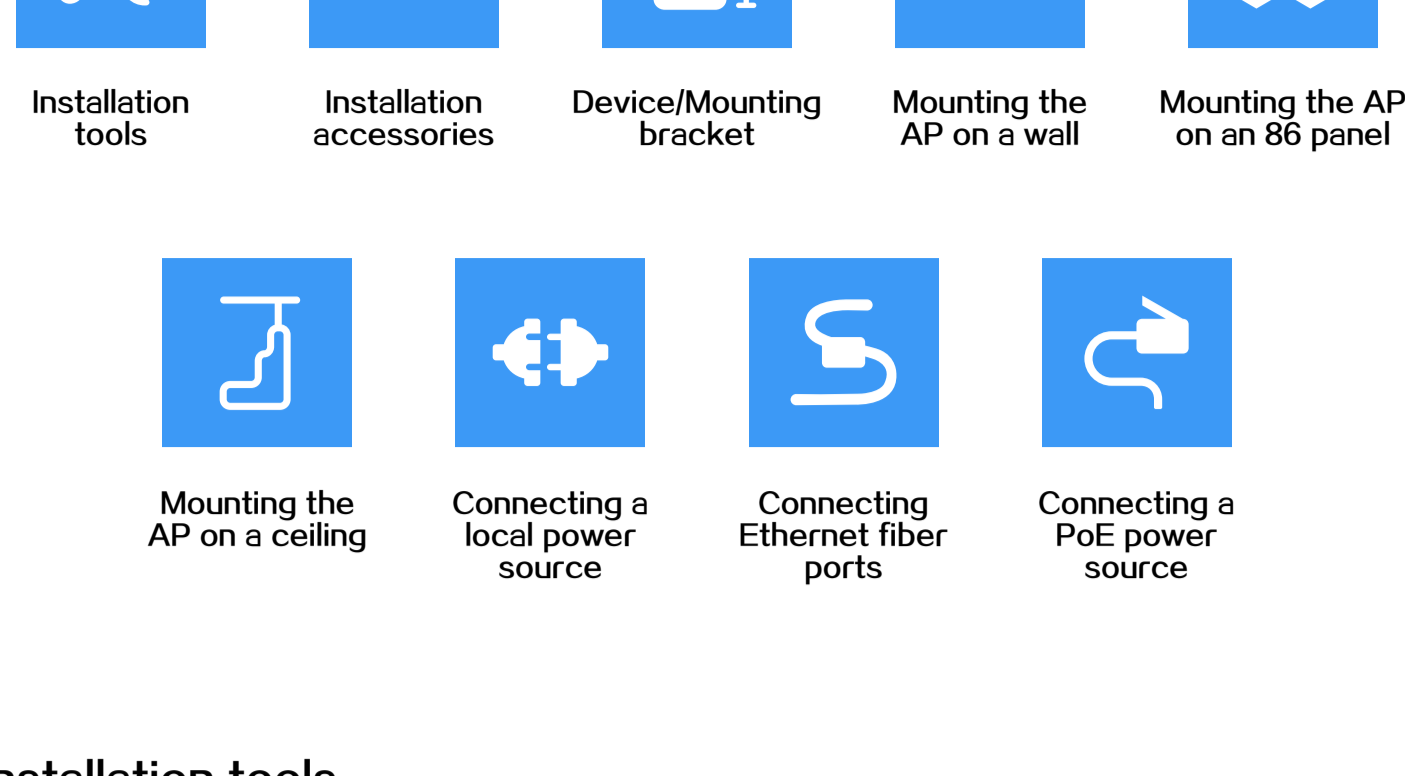

## Installation tools

When installing the AP, you might need the following tools. Prepare the installation tools yourself as required.

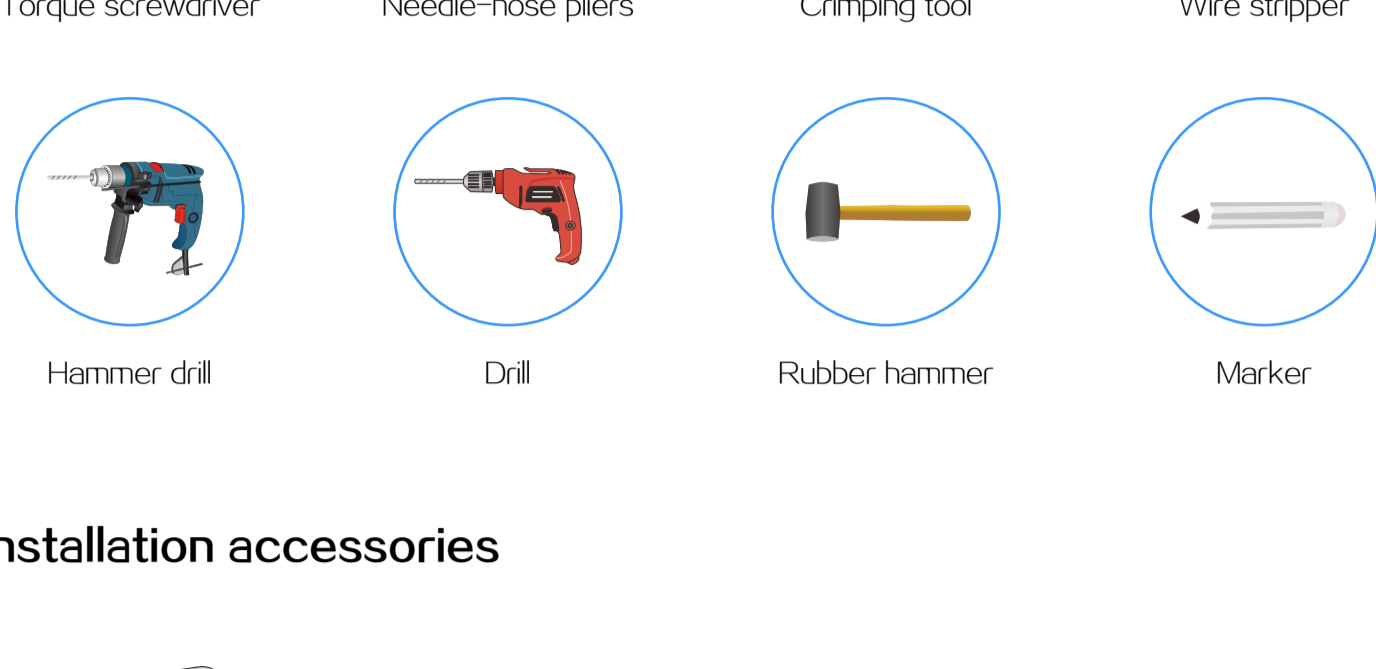

## Installation accessories

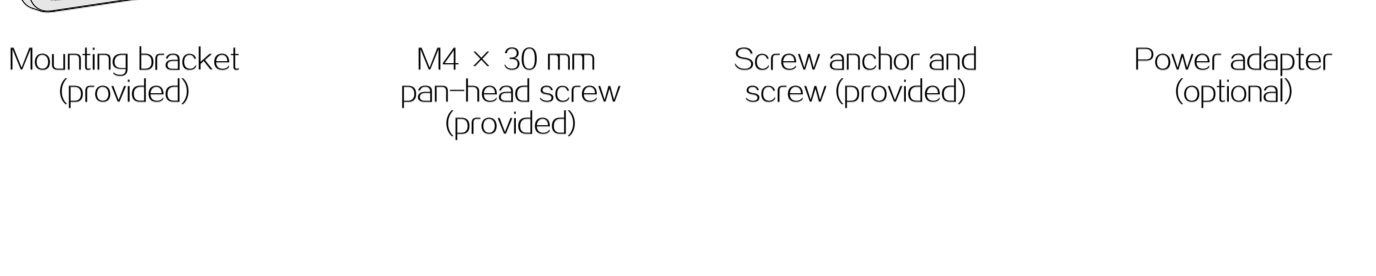

## Device/Mounting bracket

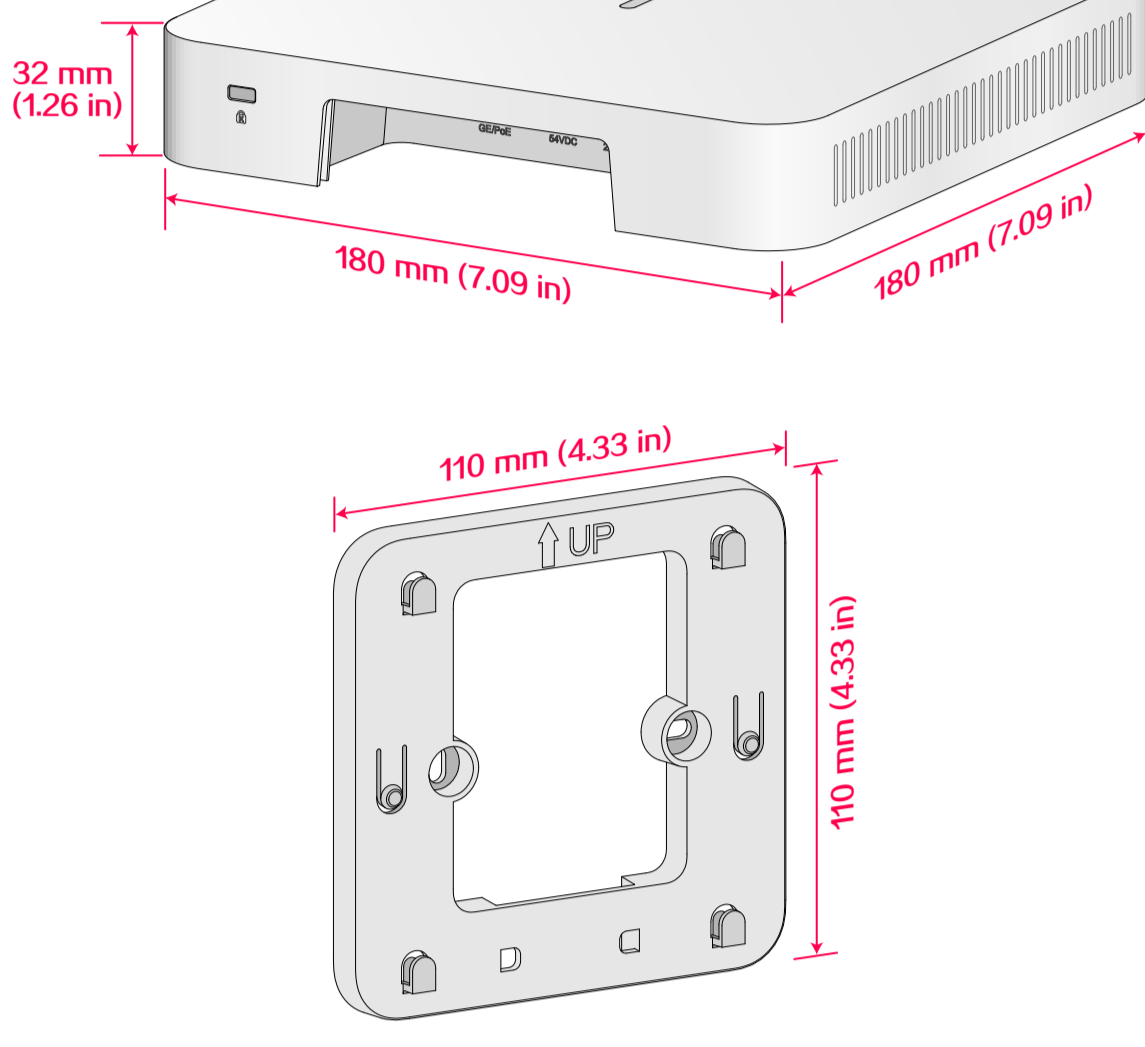

## Mounting the AP on a wall

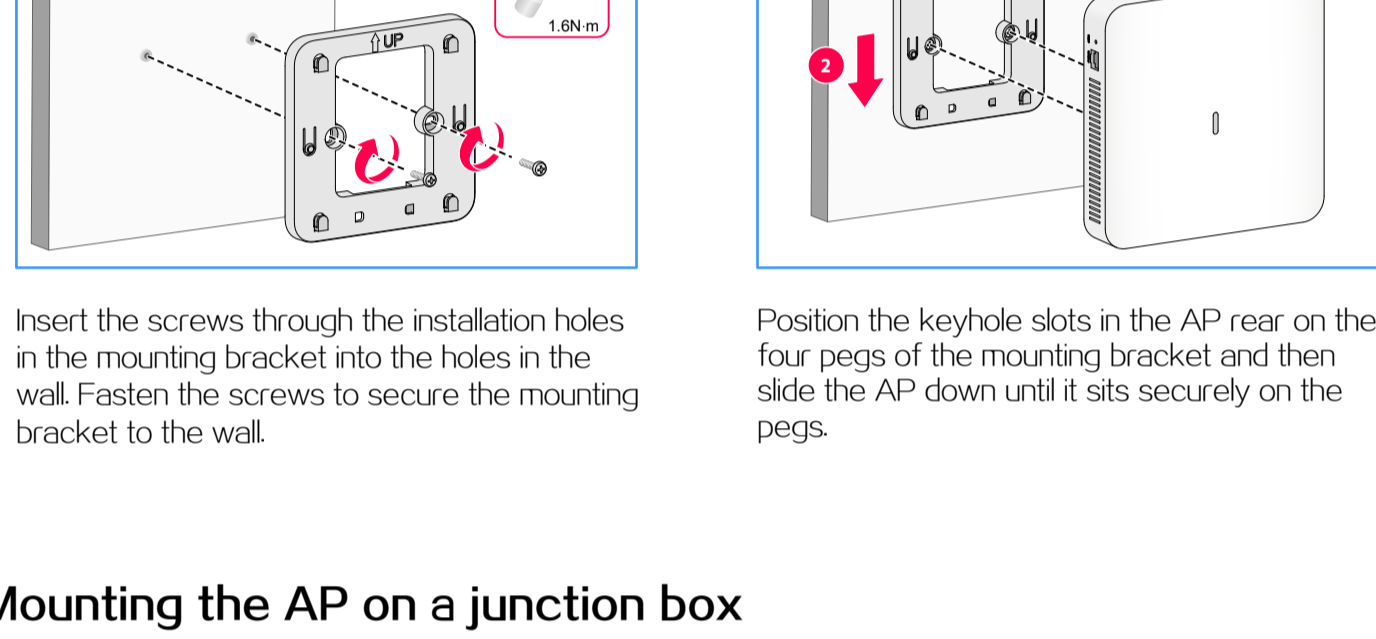
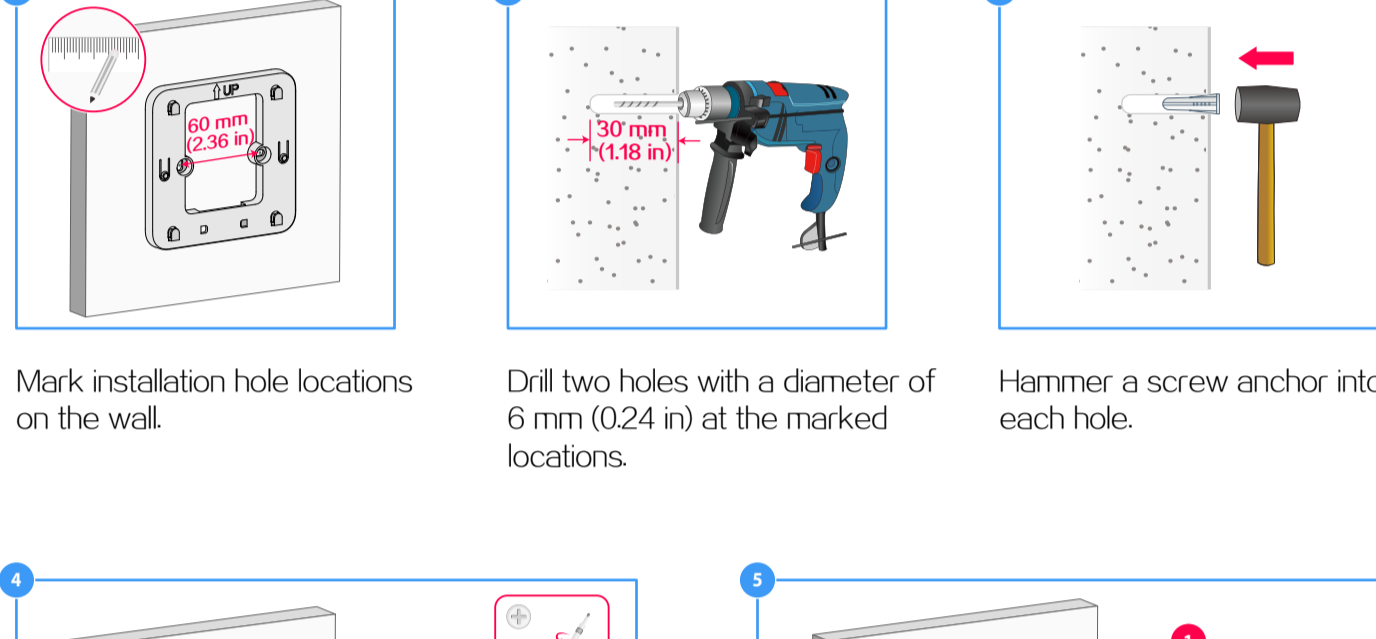

## Mounting the AP on a junction box

1. Use the provided M4 x 30 mm pan-head screws to attach the mounting bracket to the junction box.

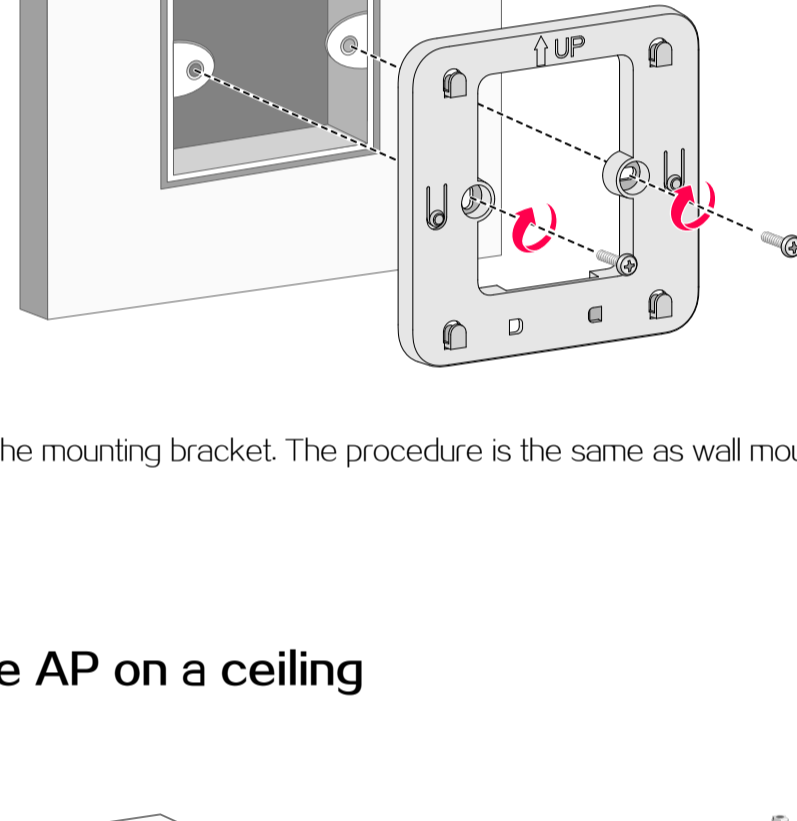

## Mounting the AP on a ceiling

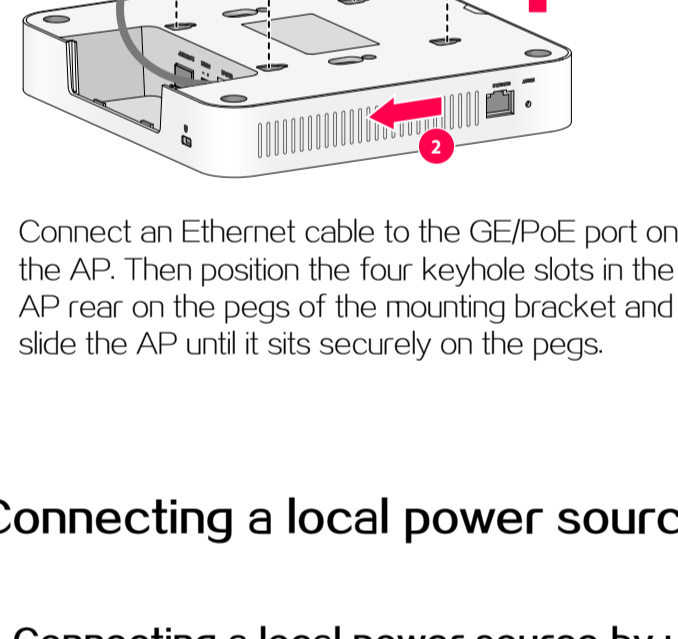
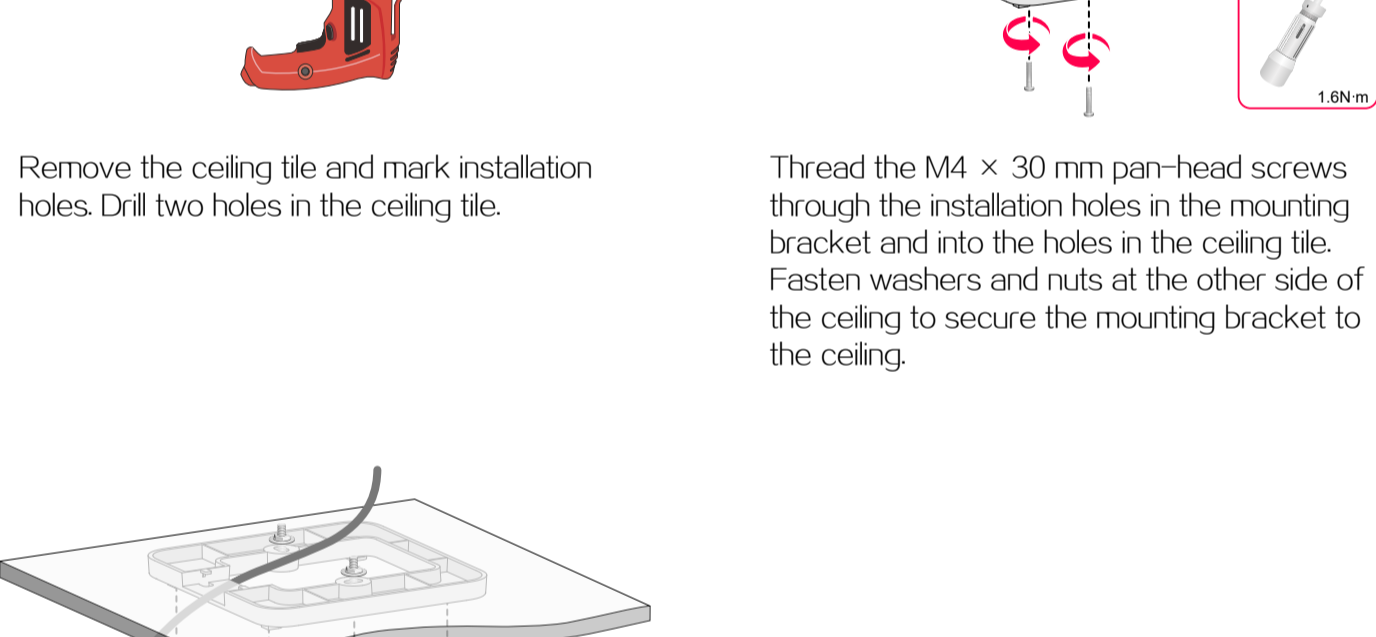

## Connecting a local power source

### 1. Connecting a local power source by using a power adapter

You can use an AC/DC power adapter to connect the AP to a local power source. No power adapter is provided with the AP. Purchase a power adapter from H3C as required.

Power adapter specifications:

Item	Specification
Input	100 VAC to 240 VAC
Output	54 V @ 0.67 A
Output power	36W

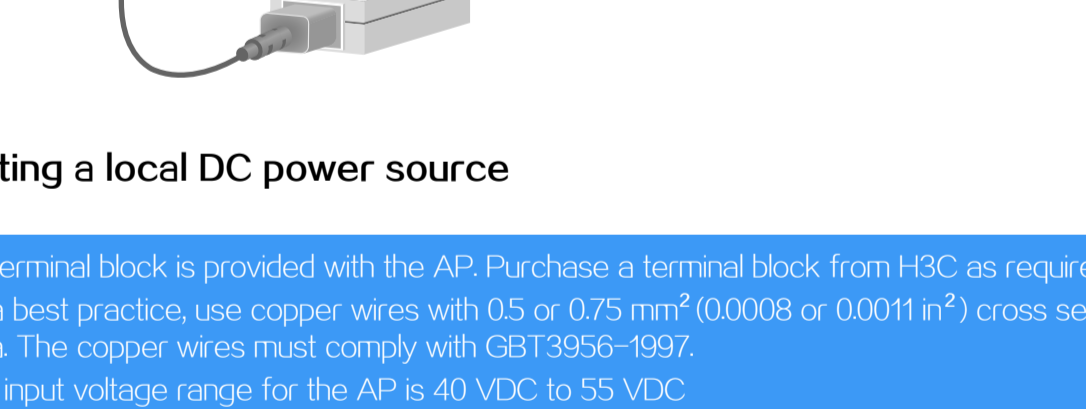

### 2. Connecting a local DC power source

- No terminal block is provided with the AP. Purchase a terminal block from H3C as required.
- As a best practice, use copper wires with 0.5 or 0.75 mm<sup>2</sup> (0.0008 or 0.0011 in<sup>2</sup>) cross sectional area. The copper wires must comply with GBT3956-1997.
- The input voltage range for the AP is 40 VDC to 55 VDC.

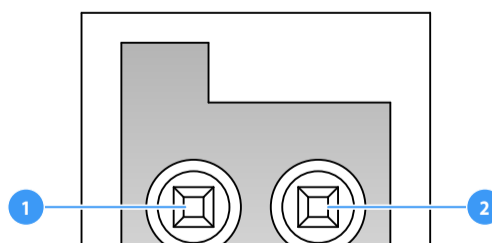
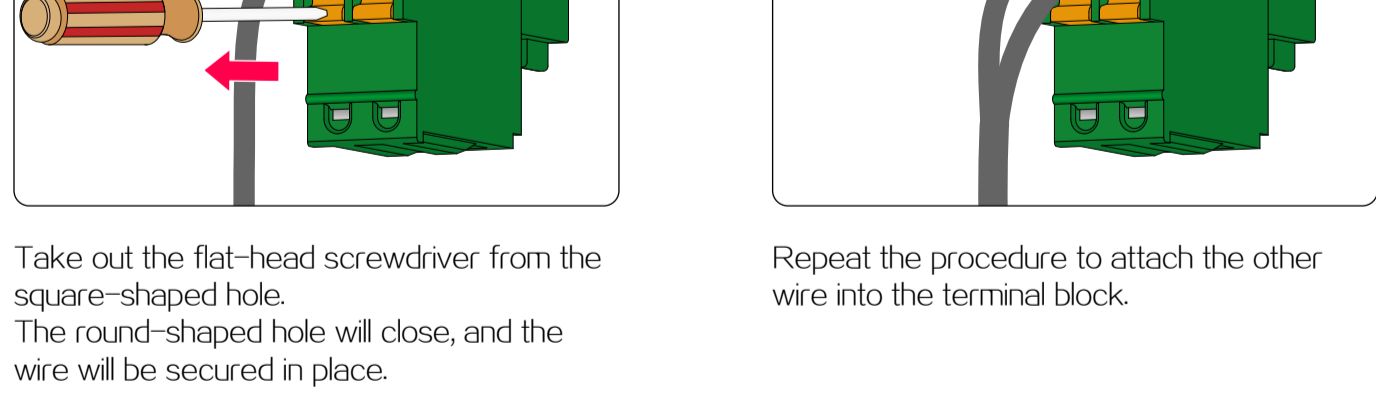
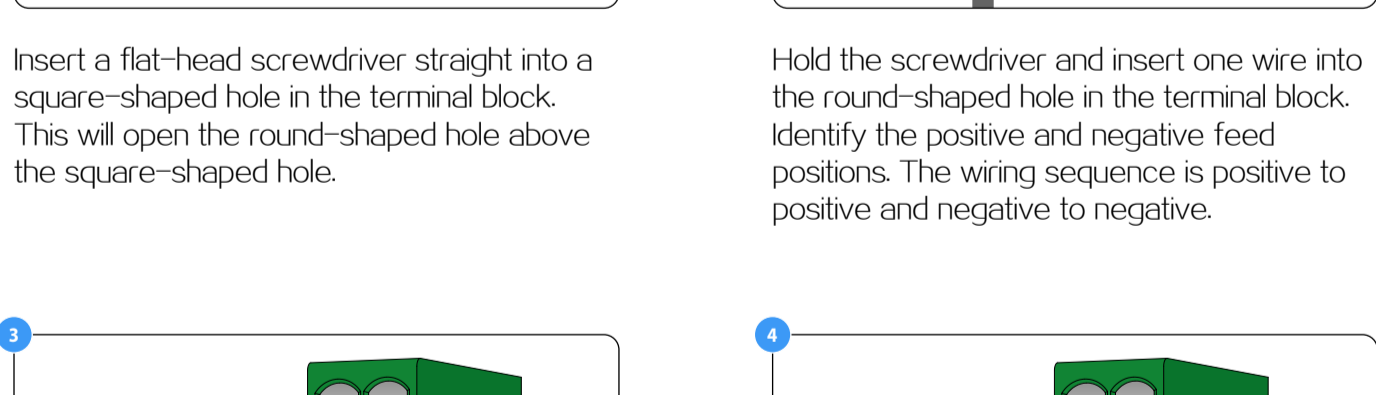

AP power port	
Pin	Description
1	Positive
2	Negative

## Connecting Ethernet fiber ports

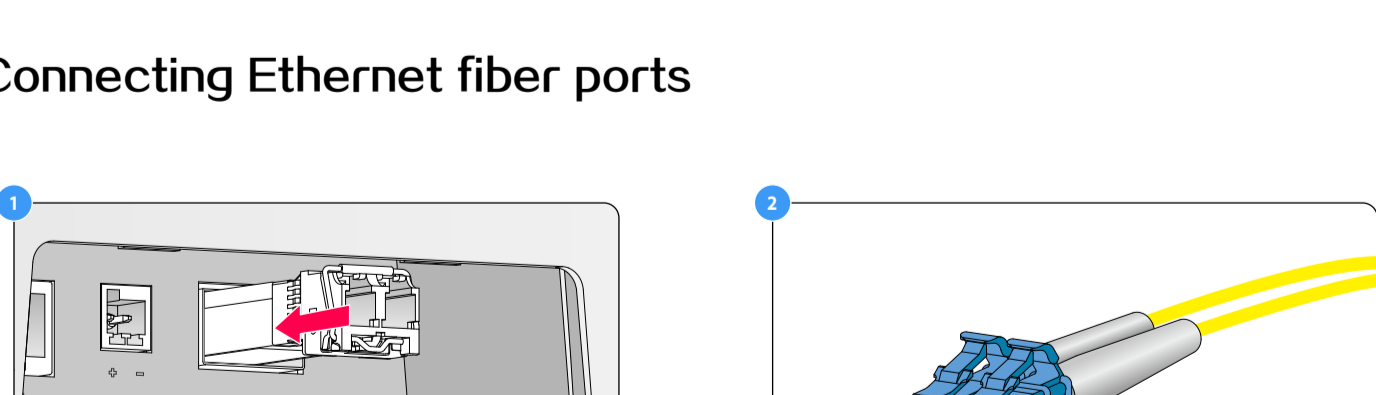

## Connecting a PoE power source

To power the AP through PoE, use an Ethernet cable to connect an Ethernet port on a PoE switch to the GE/PoE port on the AP. Attach the cable cover to the AP securely after connecting all cables.

