

H3C WA6520-SI Access Point Installation Quick Start-6W101

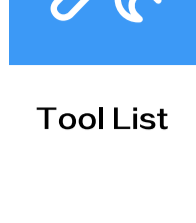

Tool List

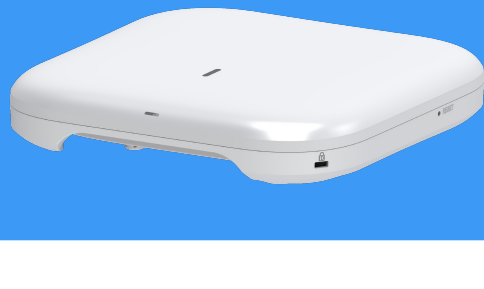
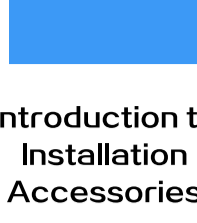

Introduction to
Installation
Accessories

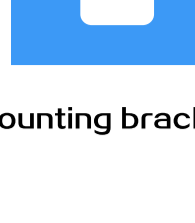

Mounting bracket



Device/Mounting
bracket



Mounting the
device

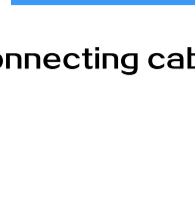

Connecting cables

Tool List



The installation tools are not provided with the AP. Prepare them yourself.



Torx 10 Phillips screwdriver

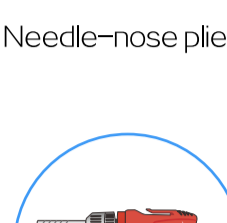

Needle-nose pliers

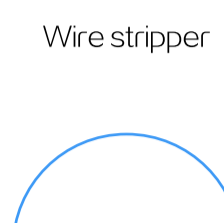

Wire stripper

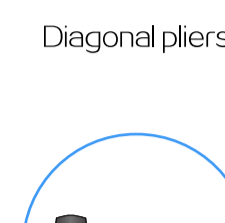

Diagonal pliers

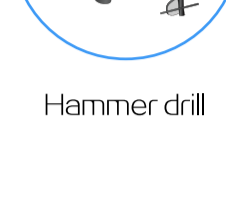

Hammer drill

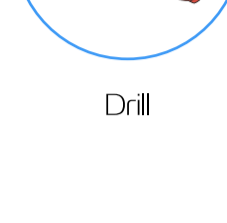

Drill

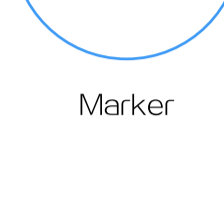

Marker

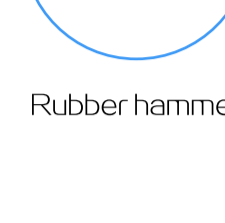

Rubber hammer

Introduction to Installation Accessories

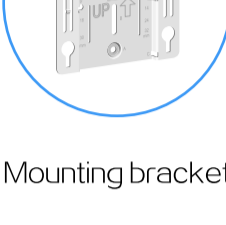

Mounting bracket

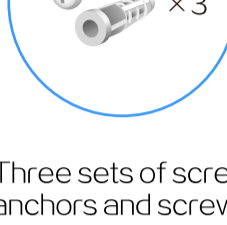

Three sets of screw
anchors and screws



M3 x 235
security screw

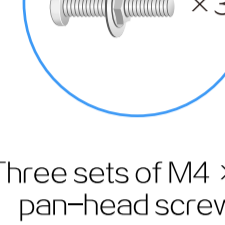

Three sets of M4 x 30
pan-head screws

Mounting bracket

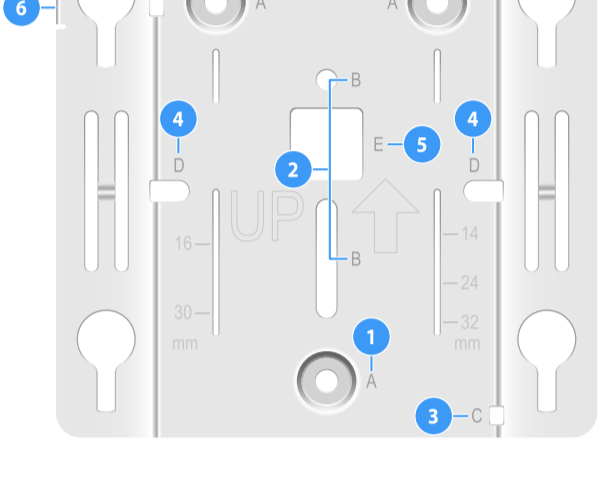

- (A holes) Wall/ceiling mounting holes, used for securing the mounting bracket to the wall/ceiling
- (B holes) T-rail mounting holes, used for securing the mounting bracket to a T-rail
- (C hole) Auxiliary cable management hole. Thread a cable tie through the hole to secure cables
- (D holes) 86 panel mounting holes, used for securing the mounting bracket to an 86 panel. The distance between the two holes is 60 mm (2.36 in)
- (E hole) Thread a cable through the hole to connect the AP
- Security hole, applicable to the M3 x 235 security screw

Device/Mounting bracket

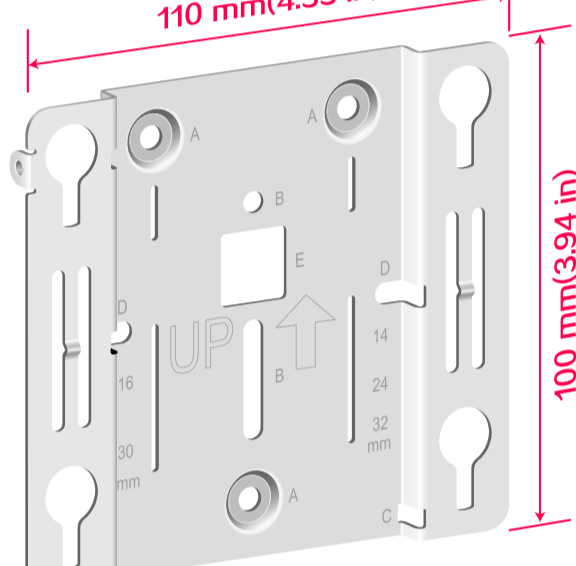
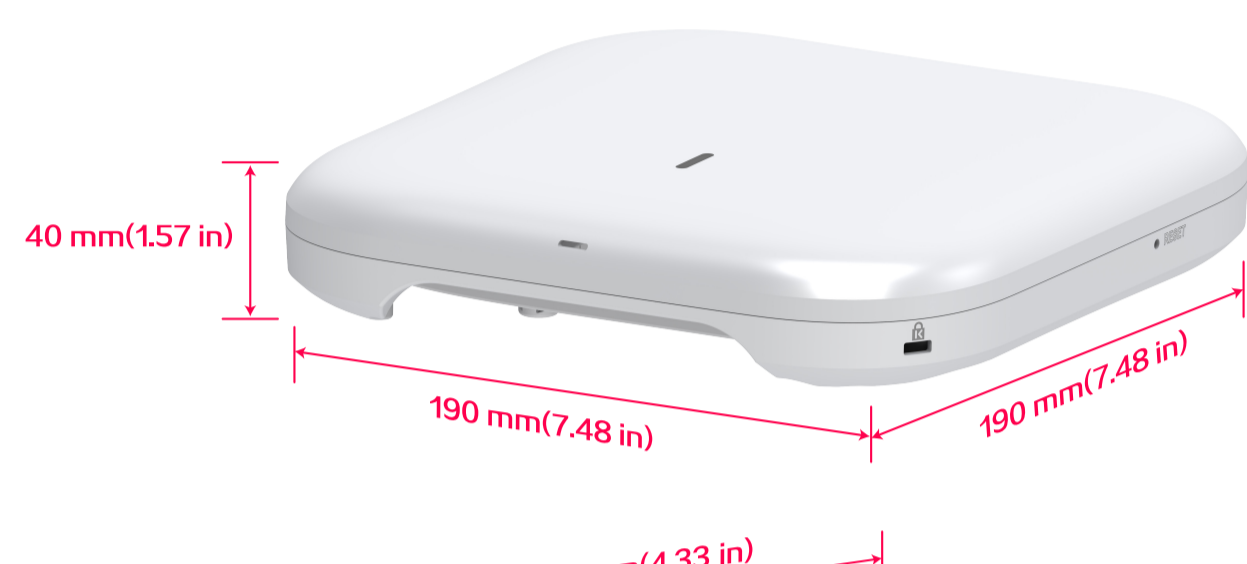

Mounting the device



- Before mounting the AP on a wall or ceiling, connect cables to the AP.
- Install an M3 x 235 security screw as required.
- Before powering on the AP, make sure you have completed all the installation steps.

Mounting the device on a wall

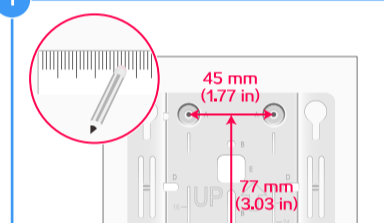

Mark installation hole locations on the wall.

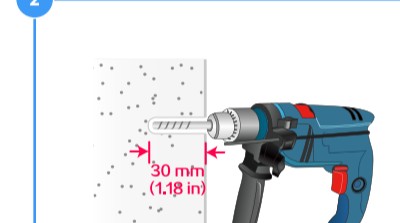

Drill three holes with a diameter of 6 mm (0.24 in) at the marked locations.



Hammer a screw anchor into each hole.

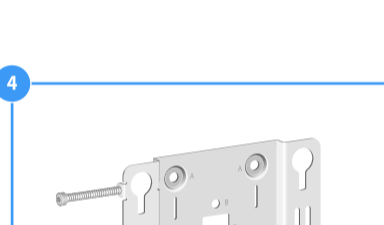

Install the M3 x 235 mm security screw into the mounting bracket. Make sure the screw does not block the keyhole slot.



Use screws to attach the mounting bracket to the wall.

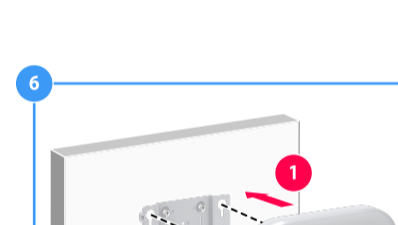

Position the four pegs at the AP rear into the mounting bracket and then slide the AP down until it sits securely in the keyhole slots.

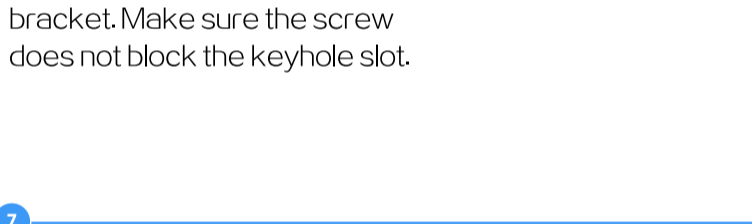

Use the Torx screwdriver to fasten the M3 x 235 mm security screw.

Mounting the device on the ceiling



The installation method of the M3 x 235 mm security screw is the same for wall mounting and ceiling mounting.



Remove the ceiling tile and mark installation holes. Drill three holes in the ceiling tile.

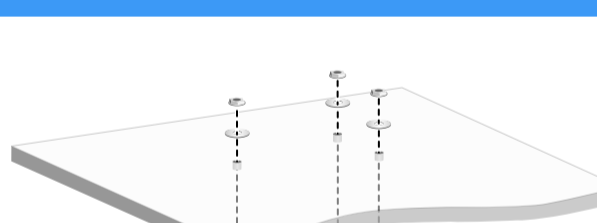

Use the pan-head screws to attach the mounting bracket to the ceiling tile.

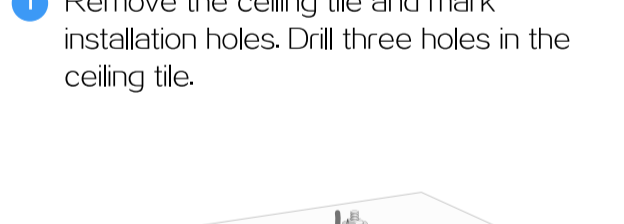

Connect a cable to the GE/PoE port. Then position the four pegs at the AP rear into the keyhole slots in the mounting bracket and slide the AP until it sits securely in the keyhole slots.

(Optional) Securing device cables for ceiling mounting

- You can use a cable tie to secure the cable before attaching the AP to the mounting bracket. First thread the cable tie through the auxiliary hole in the mounting bracket, leaving the cable tie unfastened, and then adjust the cable length and fasten the cable tie to secure the cable.
- No cable tie is provided with the AP. Prepare one yourself as required.

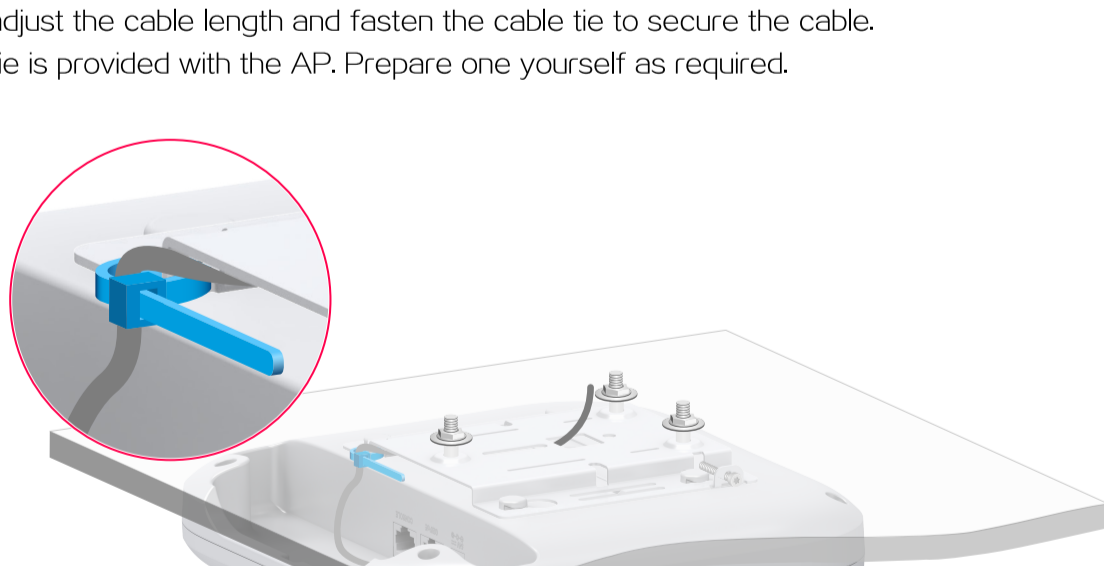

Connecting cables



The cable connection scheme varies by powering option. Select a cable connection scheme as required. For more information, see "Cable connection schemes."

Connecting a power adapter



No power adapter is provided with the device. Order it yourself.

Power adapter specifications:

Item	Specification
Input	100 to 240 VAC
Output	+48V~55VDC ⚡⚡⚡
Output power	≤20W

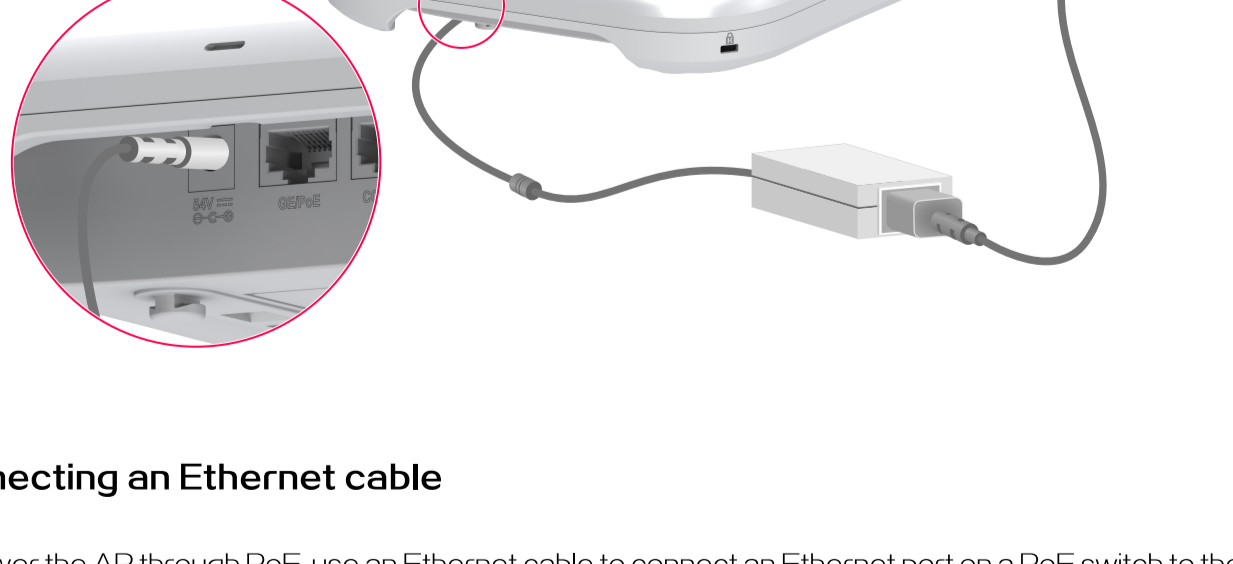

Connecting an Ethernet cable

To power the AP through PoE, use an Ethernet cable to connect an Ethernet port on a PoE switch to the GE/PoE port on the AP.

