

Call logs

Query via Web

1. Log in web page > call logs, display a list of all calls.
2. User can filter the call logs by the call log types, in, out, missed, or all.

Programmable keys

Configuration via Web

1. Log in web page Function Key > SoftKey, Select the function and fill in the number in the value items.

Do not disturb

1. Log in web page > Phone settings > Features > DND setting, and select the "DND option" is Phone or Line.
2. Check "Enable DND Timer" > Apply.

Voice mail

1. To access your voice mail box, press  key, number of messages will be indicated if provided by your server or pbx.

Network connect

Using Ethernet

1. The power on the device and connect the WAN port of the phone to the RJ45 socket of a hub/switch or a router using the Ethernet cable.
2. The default is DHCP mode.

Fanvil

V1.2

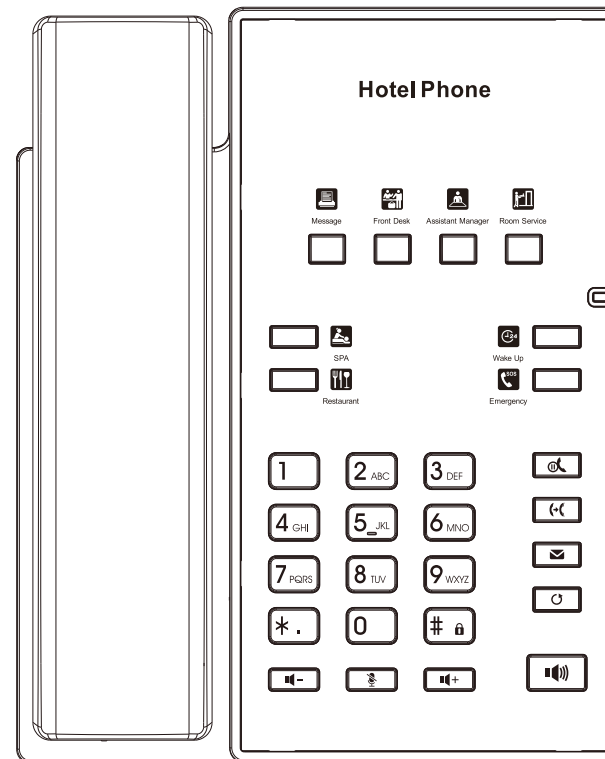

H1

Quick Installation Guide

Fanvil Technology Co., Ltd
www.fanvil.com

Regulatory Compliance

Federal Communication Commission (FCC) — USA

This device complies with Part 15 of FCC Rules. Operation is subject to the following two conditions: (1) this device may not cause harmful interference, and (2) this device must accept any interference received, including interference that may cause undesired operation.

This equipment has been tested and found to comply with the limits for a Class B digital device, pursuant to Part 15 of the FCC Rules. These limits are designed to provide reasonable protection against harmful interference in residential installation. This equipment generates, uses, and can radiate radio frequency energy, and if it is not installed and used in accordance with the instruction manual, it may cause harmful interference to radio communications. However, there is no guarantee that interference will not occur in a particular installation. If this equipment does cause harmful interference to radio or television reception, which can be determined by turning the equipment off and on, the user is encouraged to try to correct the interference by one or more of the following measures:

- Reorient or relocate the receiving antenna.
- Increase the separation between the equipment and receiver.
- Connect the equipment into an outlet on a circuit different from that to which the receiver is connected.
- Consult the dealer or an experienced radio/TV technician for help.

Warning: Any changes or modifications to this unit not expressly approved by the party responsible for compliance could void the user's authority to operate the equipment.

This equipment complies with Part 68 of the FCC rules and the requirements adopted by the ACTA. On the bottom of this equipment is a label that contains, among other information, a product identifier in the format US: 3H1PNANH1. If requested, this number must be provided to the telephone company.

Fanvil Technology Co., Ltd

Website: www.fanvil.com

E-Mail: sales@fanvil.com support@fanvil.com

Tel: +86-755-2640-2199 Fax: +86-755-2640-2618

Add: 10/F Block A, Dualshine Global Science Innovation Center,
Hongtang North 2nd Road, Bao'an District, Shenzhen, China

Packaging list

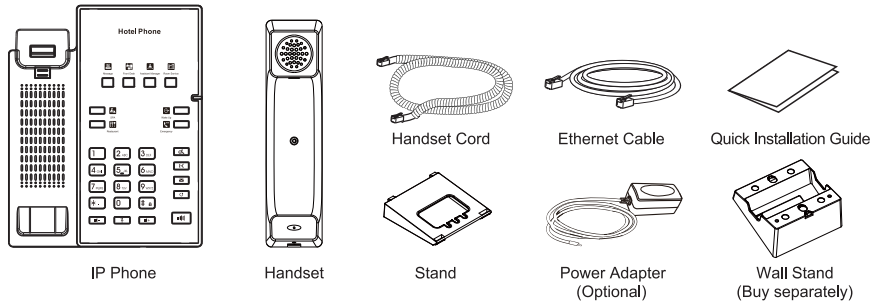

Key features

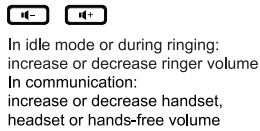
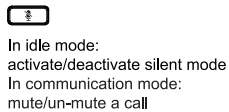
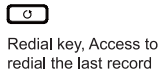
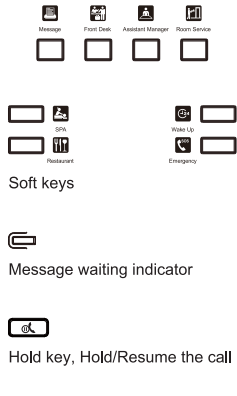

Installation the device

Please follow the instructions in below picture to install the device.

• Bracket desktop installation

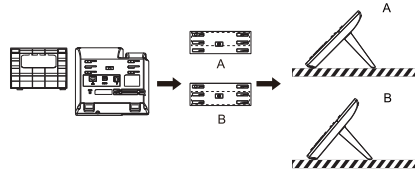

• Wall mounting (Wall Stand need buy separately)

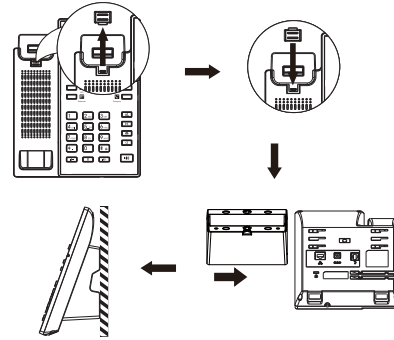

Note: The installation height of the wall-mounted bracket is less than 2 meters from the ground.

Connecting to the device

Please connect power adapter, network, and handset to the corresponding ports as described in below picture.

- ① Network port: connecting local area network or Internet.
- ② Power port: connect the power adapter.
- ③ Handset port: connect IP Phone handset.

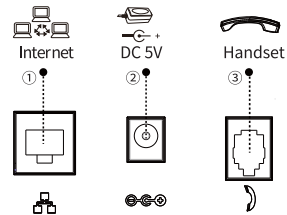

Configuration

Configuration via phone

1. Get the IP address: Press the "#" key for more than 6 seconds to broadcast IP.
2. Login: Input the IP address in the web browser. The PC and phone should be in the same IP address segment (The default username and password are both 'admin').
3. Configure: Select network/Account, etc. And fill the relevant content.
4. Save the configuration.

Making a call

1. **Pre-dialing**: enter the phone number and pick up the handset.
2. **Direct dialing**: lift the handset and enter the phone number.
3. **Handsfree**: enter phone number and press or vice versa.
4. **Memory key**: press memory key.

Accepting a call

1. **Using the handset**: pick up the handset.
2. **Using the handsfree**: press .

Redial

1. Press , redial a call number.

Call Mute

1. Press to Mute the microphone during the call.
2. Press again to un-mute the conversation.

Putting a call on hold

1. Press key during an active call.
2. To retrieve the call press key.

Call transfer

Attended transfer

1. Press key during the active conversation, the call is put on hold.
2. Dial the second telephone number and press "Dial" or "#".
3. When the call is answered, then press key to complete the operation.

Blind transfer

1. Press key during the active conversation, the call will be on hold.
2. Then enter the 2nd telephone number and press key.